

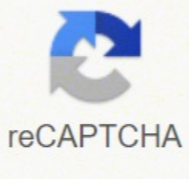

I'm not robot



Open

Sharper image alexa speaker manual

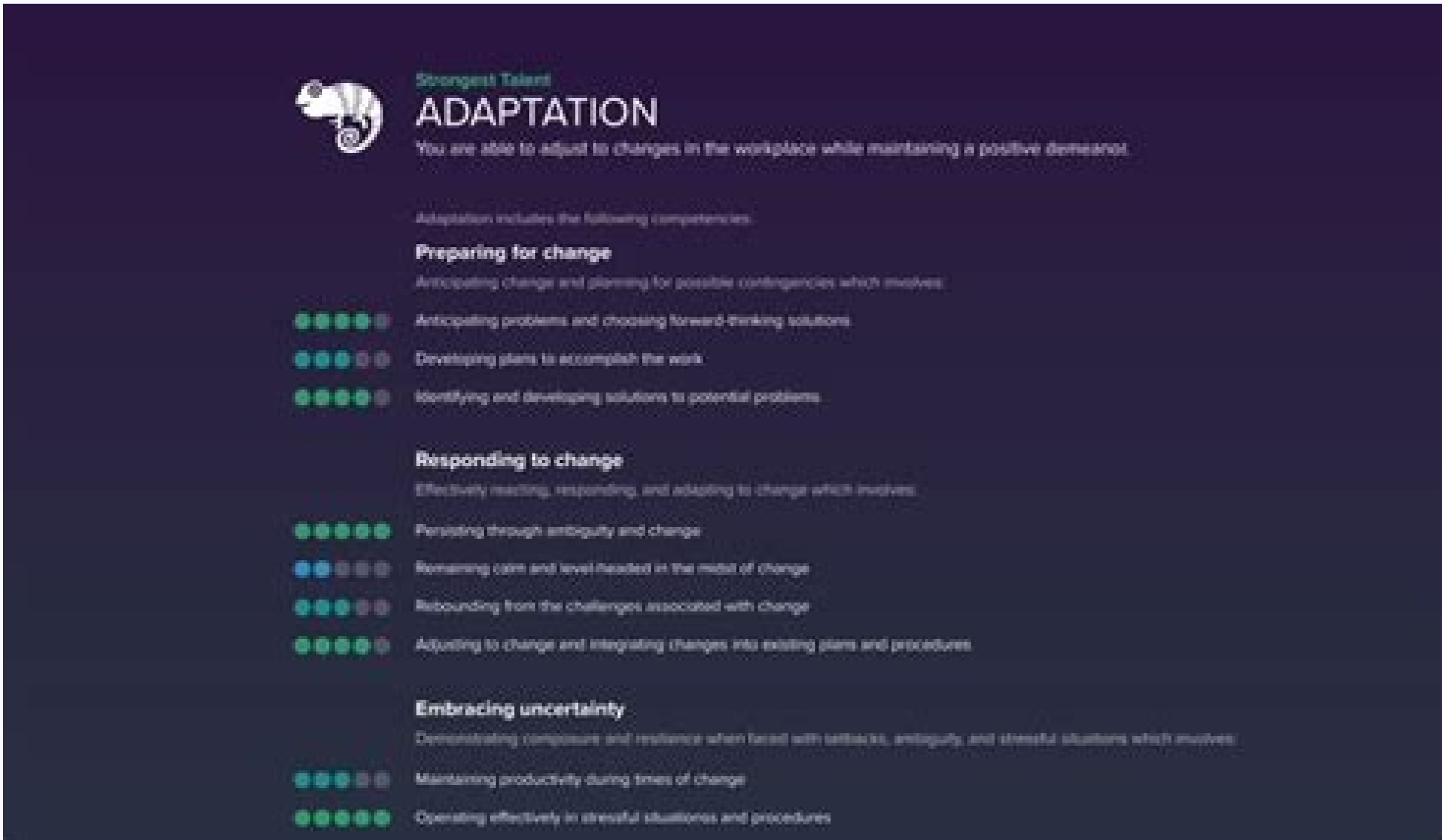
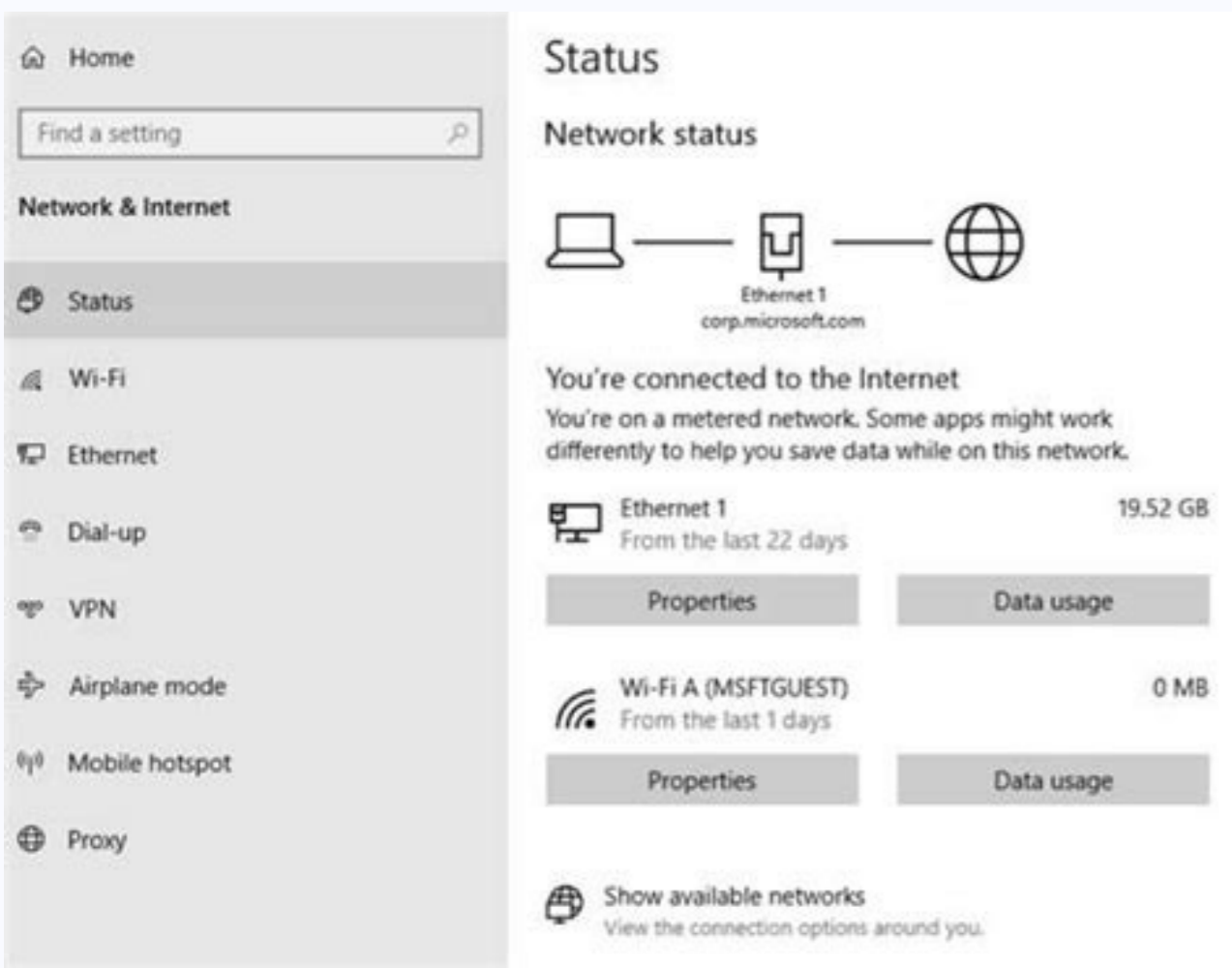

The Bip U Pro is also waterproof to 50 meters, and can track both pool and open water swimming. The whole body is made up of polycarbonate, and is built well. If you are not happy with the options here, you can explore a fine collection of them in the companion Zepp application. The Bip U Pro comes with stress tracking, breathing exercise, and the PAI Health Assessment system which gives points based on how active and how regularly you've been giving your heart a good workout. The usage also included daily workout for about 15 minutes and a bit of walking with brightness set to 75% and heart rate, SpO2 set to manual and sleep tracking enabled. However, when you take the smartwatch to run or walk with GPS turned on, the battery will drain faster. One good thing about the watch's software is that most of the features are added on the watch itself for customization rather than depending on the app all the time. For instance, the button is used to wake the screen, open the menu, go back, and a long press function can also be customized on the watch itself. Sometimes we wished the peak brightness was a bit higher - but that's not a deal-breaker. It works only if your hand is stable. To access the notifications, you can swipe up on the home screen. While there's no option to store or access third-party music streaming apps, you can control media on your phone, which you can play/pause, skip forward and back, and control volume. You can choose between activity goals, PAI, heart rate, sleep, workout, history, SpO2, stress, breathing, and much more. On the back, there is a BioTracker 2 PPG biological optical sensor to measure your heart rate. You can opt for all-day stress tracking or measure it manually. We also did a manual 100 step count a few times and we got 98% accuracy, which is impressive. We're using the black variant for our review. By playing with some notifications settings and customizing what notifications show up on the watch, you can get slightly better battery life. You can pick from over 50 watch faces and a few of them are customizable as well. The company also claims the watch can be used to control smart devices. For anyone who's looking out for a decent fitness tracker with GPS onboard, the Bip U Pro is a good choice. Apart from that, you get reminders to stand up and a notification when your daily goal is reached. In a nutshell, the Bip U Pro is again one of the most featured packed fitness trackers in the budget segment with heart rate, SpO2, sleep monitoring, swim tracking, and built-in GPS - all of which work well. Using GPS means the battery will drain quicker, so make sure you check the battery status after you return from any outdoor activities. Sleep tracking in wearables is one of my favourite features, and the Bip U Pro nails it here with extremely accurate data. While these two are welcome additions in the cheap wearable space, only the former is reliable. The Alexa integration adds very little value to the smartwatch experience here. The wearable is also quite thick, measuring 11.4mm, but not heavy on your wrist at just 31g. Even with some rough usage during our review period, we are happy to report the watch had no scratches. All of these functions worked well. Other features include detailed weather updates for the next five days. In fact, it is the same as the Bip U - including the weight, bezels, button layout, and sensor placements. The Bip U Pro and Bip U are so similar that I accidentally took out the Bip U to track my run, only to realize this had no GPS. The Bip U Pro is available in black, green and pink color options. In terms of tracking, the wearable can track more than 60 sports. We have nothing to complain about when it comes to the build quality of the device, especially for the price. (Image credit: Srivatsa Ramesh) The display is also the same as the Bip U's, measuring 1.43 inch with a resolution of 320 x 302 pixels. You also have the option to set heart rate interval from one minute to every 30 minutes, or you can completely turn off and measure it manually - which also helps to extend battery life. While that might sound cool for a budget smartwatch, the actual experience wasn't that great. Setting up Alexa on the watch itself is an arduous process. The app experience isn't entirely smooth though. The heart rate measurement was pretty accurate as well and worked like charm every time. We bumped that to 75% outdoors, and 100% on some extremely sunny days. The display is protected with curved Corning Gorilla Glass 3 for additional protection. The clip fits securely to the back and won't fall off easily. Pressing the button on the side will bring up a list of menus - Activity Goal, PAI, Heart Rate, Sleep, Workout, Workout History, SpO2, Stress, Breathing, Cycle Tracks, Alarm, Settings, and more. You also get the auto screen off, screen saver, lit up the screen when a notification arrives, options that can be turned on/off if and when needed. Overall the UI performance was snappy and I had no issues navigating. It not only tracks your sleep time and awake time, but the app also provides data like sleep stages - deep sleep, light sleep, REM (rapid eye movement), and even offers you a sleep score. The settings and options on the app are all over the place and we wish Huawei had organized it in a better way. Image 1 of 3 (Image credit: Srivatsa Ramesh) Image 2 of 3 (Image credit: Srivatsa Ramesh) Image 3 of 3 (Image credit: Srivatsa Ramesh) In terms of the usability of Alexa, firstly you can access Alexa by swiping right on the home screen which brings a "Connecting to Alexa" prompt that takes about two to five seconds to change to "Alexa is listening" with a subtle vibration. As for the smart features, you get Alexa, notification mirroring, music control, and a camera shutter. Being one of the few smartwatches to offer built-in GPS for Rs 4,999 / \$59.99 / £59 (about AU\$80) itself makes the Amazfit Bip U Pro one of our recommendations. These modes, activity tracking and the presence of a built-in GPS should satisfy a buyer at this price point. Smart features (Image credit: Srivatsa Ramesh) While the budget smartwatches come with a plethora of sports modes to track, the one area where all of them fall behind is in terms of smart features. Unlike other Amazfit smartwatches, the Bip U Pro lacks support for offline commands and Bluetooth calls. You can ask very basic questions to the voice assistant and it will respond in the form of text and show up on the tiny screen. Battery life (Image credit: Srivatsa Ramesh) Huawei claims the Amazfit Bip U Pro can last up to nine days with typical usage and up to five days with heavy usage. The GPS tracking works well, and gives accurate results. Apart from these two major additions, everything else is pretty much the same as we'd seen on the Amazfit Bip U. Lastly, the touch experience was also very responsive and easy to use throughout the review period. You can choose different watch faces by long pressing on the home screen. The pairing process is straightforward, but once it's connected, you have to put some effort to get the exact menu you're searching for. The selling point of the phone is the built-in GPS for all your outdoor activity tracking. The BioTracker 2 PPG optical sensor delivers continuous heart rate monitoring. The Amazfit Bip U can track over 60 sports including badminton, cricket, swimming, free workout, cycling, rope skipping, rowing, and dance among major ones. In terms of sensors, you get accelerometer and gyroscope motion sensors to track indoor activity, show step counts, and enable automatic sleep tracking. Apart from that, the basic tracking data is pretty accurate and results are represented well on the app as well as the watch. It also records heart rate throughout the workout with zones, pace, and cadence. Image 1 of 3 (Image credit: Srivatsa Ramesh) Image 2 of 3 (Image credit: Srivatsa Ramesh) Image 3 of 3 (Image credit: Srivatsa Ramesh) The SpO2 sensor brings the ability to take blood oxygen measurements which is a nifty addition considering the situation we are going through. The Bip U Pro can hold up to 10 notifications at once, and notifies you of the incoming calls with the option to reject or silent the incoming call. However, to make it work, you will need to place your hand on a table, and even a slight moment in hand will fail in securing the score. You get stats for steps taken, the number of times you've stood up, calories burnt, distance travelled and your target steps. This is frustrating because we had the same issue with Bip U and the company hasn't fixed the issue even after several months. In a nutshell, you should be able to pull off at least three days of battery life even with the heaviest of usages such as GPS, heart rate, SpO2, and multiple notifications. Recharging the battery is a straightforward process, the Bip U Pro magnetically attaches to the back of the included charging cradle. Apart from Alexa integration, the app also supports WeChat, Google Fit,

